

# AGENDA

---

**Meeting:** Southern Area Licensing Sub Committee  
**Place:** The Enterprise Network, The Old Fire Station, Salt Lane, Salisbury, SP1 1DU  
**Date:** Thursday 4 January 2018  
**Time:** 10.30 am  
**Matter:** Application for a Premises Licence - Mauls

---

Please direct any enquiries on this Agenda to Lisa Moore 01722 434560, of Democratic Services, County Hall, Bythesea Road, Trowbridge, direct line 01722 434560 or email [lisa.moore@wiltshire.gov.uk](mailto:lisa.moore@wiltshire.gov.uk)

Press enquiries to Communications on direct lines (01225) 713114/713115.

This Agenda and all the documents referred to within it are available on the Council's website at [www.wiltshire.gov.uk](http://www.wiltshire.gov.uk)

---

## Membership:

Cllr Jose Green  
Cllr Mike Hewitt

Cllr Trevor Carbin

---

## Reserve:

Cllr Robert Yuill

---

## **Recording and Broadcasting Information**

Wiltshire Council may record this meeting for live and/or subsequent broadcast on the Council's website at <http://www.wiltshire.public-i.tv>. At the start of the meeting, the Chairman will confirm if all or part of the meeting is being recorded. The images and sound recordings may also be used for training purposes within the Council.

By entering the meeting room you are consenting to being recorded and to the use of those images and recordings for broadcasting and/or training purposes.

The meeting may also be recorded by the press or members of the public.

Any person or organisation choosing to film, record or broadcast any meeting of the Council, its Cabinet or committees is responsible for any claims or other liability resulting from them so doing and by choosing to film, record or broadcast proceedings they accept that they are required to indemnify the Council, its members and officers in relation to any such claims or liabilities.

Details of the Council's Guidance on the Recording and Webcasting of Meetings is available on request.

## **Parking**

To find car parks by area follow [this link](#). The three Wiltshire Council Hubs where most meetings will be held are as follows:

**County Hall, Trowbridge**  
**Bourne Hill, Salisbury**  
**Monkton Park, Chippenham**

County Hall and Monkton Park have some limited visitor parking. Please note for meetings at County Hall you will need to log your car's registration details upon your arrival in reception using the tablet provided. If you may be attending a meeting for more than 2 hours, please provide your registration details to the Democratic Services Officer, who will arrange for your stay to be extended.

## **Public Participation**

Please see the agenda list on following pages for details of deadlines for submission of questions and statements for this meeting.

For extended details on meeting procedure, submission and scope of questions and other matters, please consult [Part 4 of the council's constitution](#).

The full constitution can be found at [this link](#).

For assistance on these and other matters please contact the officer named above for details

1        **Election of Chairman**

To elect a Chairman for the meeting of the Sub Committee.

2        **Apologies for Absence/Substitutions**

To receive any apologies for absence and to note any substitutions.

3        **Procedure for the Meeting** (*Pages 5 - 12*)

The Chairman will explain the attached procedure for the members of the public present.

4        **Chairman's Announcements**

The Chairman will give details of the exits to be used in the event of an emergency.

5        **Declarations of Interest**

To receive any declarations of disclosable interests or dispensations granted by the Standards Committee.

6        **Licensing Application** (*Pages 13 - 18*)

To consider and determine an Application for a Premises Licence by Maults Wine & Cheese Bar Ltd. in respect of Maults Wine & Cheese Bar, 3 Fish Row, Salisbury, SP1 1EX. The report of the Public Protection Officer (Licensing) is attached.

6a        **Appendix 1 - The Legislative Reform (Entertainment Licensing) Order 2014 - Entertainment Exemptions** (*Pages 19 - 22*)

6b        **Appendix 2 - Application for a Premises Licence** (*Pages 23 - 48*)

6c        **Appendix 3 - Plan of Premises** (*Pages 49 - 50*)

6d        **Appendix 4 - Location Plan of Premises** (*Pages 51 - 52*)

6e        **Appendix 5 - Relevant Representations** (*Pages 53 - 54*)

This page is intentionally left blank

## LICENSING COMMITTEE

### PROCEDURAL RULES FOR THE HEARING OF LICENSING ACT 2003 APPLICATIONS

#### 1 Purpose

- 1.1 These rules have been prepared to facilitate proper consideration of licence applications, made under the Licensing Act 2003, by the Licensing Committee and its Sub Committees.
- 1.2 The rules set out a framework for how applications are to be heard and explain the role of the participants at the Hearing.

#### 2 Definitions

- 2.1 The following definitions describe the participants at and the subject matter of a Hearing:

**“Applicant”** means the person who has submitted an Application for consideration by the Committee.

**“Applicant’s Premises”** means premises subject to the Application.

**“Applicant’s Representative”** means a person attending a Hearing to assist or represent an Applicant including a lawyer.

**“Application”** means an application for the Grant/Variation/Transfer/Review and any other decision to be made by the Committee/Sub-Committee in respect of a Licence.

**“Chairperson”** means the Member who is the Chairperson of the Committee for the particular Hearing.

**“Committee”** means the Council’s Licensing Committee and includes any Sub Committee of the Licensing Committee.

**“Committee Lawyer”** means the Council’s Lawyer (including an external Lawyer instructed by the Council’s Legal & Democratic Services Manager) who is present at a Hearing to advise the Chairperson and the Members.

**“Committee Manager”** means the Council’s Officer who is present at a Hearing to take minutes.

**“Committee Report”** means the Licensing Officer’s written report to the Committee concerning an Application, a copy of which has been previously made available to the Applicant or their Representative, a Responsible

Authority or their Representative or any person who has made a Relevant Representation or their Representative.

**“Hearing”** means a meeting of the Committee at which an Application is considered.

**“Licence”** means a Licence which the Committee has the power or duty inter alia to grant, transfer, suspend or revoke.

**“Licensing Officer”** means the Council’s Licensing Officer(s) who is/are present at a Hearing to present reports in respect of an Application and to give technical advice in respect of an Application to the Committee when requested.

**“Licensing Authority”** the Council in whose geographical area the subject matter of the Application relates to, and includes the Council’s Licensing Committee, any Sub Committee of the Licensing Committee and a Licensing Officer.

**“Member”** means a Member who is a Member of the Committee that is considering an Application.

**“Person making a Relevant Representation”** means a person who is present at a Hearing to make representations in respect of an Application and includes any person who is present to assist or make representations on behalf of that person including a Lawyer.

**“Responsible Authority”** means a person who is present at a Hearing to make representations in respect of an Application in their capacity as Responsible Authority and includes any person who is present to assist or make representations on behalf of the Responsible Authority including a Lawyer.

### **3 Key Principles**

- 3.1 The principles of ‘natural justice’, and Article 6 ‘Right to a Fair Trial’, which is one of the Convention Rights in the Human Rights Act 1998, require that there is a fair Hearing of Applications.
- 3.2 Natural justice is an umbrella term for the legal standards of basic fairness. This will include that:
  - 3.2.1 the Applicant has an opportunity to make representations before a decision is made;
  - 3.2.2 those making representations have an opportunity to voice their representations before a decision is made;
  - 3.2.3 the Applicant has an adequate opportunity to consider and respond to any submissions made by a Responsible Authority/Authorities and/or any person/s who have made a Relevant Representation;

- 3.2.4 the Committee does not exclude an Applicant from a Hearing in order to consider submissions from a Responsible Authority/Authorities and/or any person/s who have made a Relevant Representation.
- 3.3 It is also fundamental that there is an orderly presentation of submissions at a Hearing so that the relevant issues are properly understood, evidence is tested and that oral statements made at the Hearing are accurately recorded.
- 3.4 Ultimately the Chairperson determines the application of these rules, having regard to any submissions being made by those present and in particular the Committee Lawyer.

## **4 The Hearing**

- 4.1 The Hearing shall take place in public.
- 4.1.1 The Committee may exclude the public from all or part of the Hearing where it considers it to be in the public interest to do so and, in accordance with the Local Government (Access to Information) Act 1985, as amended. Public includes a party and any person assisting or representing a party.
- 4.1.2 The Committee may require any person attending the Hearing who, in its opinion, is behaving in a disruptive manner, to leave the Hearing and may:
- A refuse to permit them to return;
  - B permit them to return only on such conditions as the Committee may specify;
  - C in the event that a person is required to leave a Hearing that person may, before the end of the Hearing, submit to the Committee in writing any information which they would have given orally.
- 4.2 Prior to the Hearing commencing, the Chairperson shall advise the parties of the procedure it proposes to follow at the Hearing.
- 4.3 Where a party has previously requested permission for a person(s), other than their representative, to appear at the Hearing then the Committee shall consider whether to permit that request.
- 4.4 The Committee will allow the parties an equal maximum period of time in which to exercise their rights.
- 4.5 This equal maximum time may have been notified in advance of the Hearing;
- 4.6 Where there are a number of people who have attended the Hearing to make the same representation then the Committee would normally require that a spokesperson be appointed by them to make the representations on behalf of all of those who have made Relevant Representations .

## **5 Presentation of Submissions**

- 5.1 The Chairperson will introduce the Application.
- 5.2 In the event that the Licensing Authority has given notice to a party requiring clarification on a point(s) then that party shall respond to the points raised by the Licensing Authority.
- 5.3 Submissions shall be made in the following order unless the Chairperson directs otherwise:
  - 5.3.1 The Licensing Officer will orally present the Committee Report and will in particular advise the Committee as to:
    - A the options available to it;
    - B the considerations that are relevant in reaching its decision.
  - 5.3.2 The Applicant (or the Applicant's Representative) will orally present its submission which may include:
    - A presenting their case in accordance with the papers, which will have been circulated with Agenda papers;
    - B confirming key information and answer pertinent questions; and
    - C calling witnesses in support of the Application (see paragraph 4.3).
  - 5.3.3 A Responsible Authority/Authorities and/or any person/s who have made a Relevant Representation will orally present their representations in turn which shall include:
    - A the grounds of the representation to the Application; and
    - B any condition(s) that the Responsible Authority/Authorities and/or any person/s who have made a Relevant Representation would be happy to have the Application granted subject to which would cause the representation to be withdrawn.

## **6 Questioning of Submissions**

- 6.1 The Chairperson will regulate the order in which questions are asked by Members.
- 6.2 The Chairperson and Members, voiced through the Chairperson, may question any party following the completion of their submission.
- 6.3 The Chairperson will normally permit the Applicant, a Responsible Authority/Authorities or any person/s who have made a Relevant Representation to ask questions through them of the other parties.
- 6.4 The Chairperson may direct that questions which are not relevant to the Application or one of the four Licensing Objectives are not formally put or answered.



## **7 Documentation**

- 7.1 No party shall present new documentation to the Committee at the Hearing other than with the consent of all of the other parties. This does not preclude the Licensing Officer from correcting errors, providing updated information or an extract from a local map showing the Applicant's Premises in the context of the surrounding premises and any person/s who have made a Relevant Representation . If any party is granted permission to present supplementary papers at the Hearing they shall provide at least 10 copies at the start of their submission.

## **8 Intervention**

The Chairperson shall permit the following interventions at any point in the Hearing:

- 8.1 The Committee Lawyer to advise the Committee on issues of law, procedure and relevant considerations on decision making. If necessary, the Chairperson may require the Committee, the Committee Lawyer and the Committee Manager to leave the Hearing so that advice can be given.
- 8.2 The Committee Manager to advise the Committee on procedure generally, or to request that statements made are repeated for reasons of clarity and so that they can be properly recorded.
- 8.3 The Licensing Officer to seek to clarify statements that have been made in light of information held on their file.

## **9 Failure of Parties to Attend Hearing**

- 9.1 If a party has informed the Licensing Authority that it does not intend to attend or be represented at a Hearing, the Hearing may proceed in its absence.
- 9.2 If a party has not indicated that it does not intend to attend or be represented at a Hearing and fails to attend or be represented at the Hearing then the Licensing Authority may:
- 9.2.1 where it considers it be necessary in the public interest, adjourn the Hearing to a specified date; or
- 9.2.2 hold the Hearing in the party's absence.
- 9.3 Where the Licensing Authority holds a Hearing in the absence of a party, it shall consider at the Hearing the application, representations or notice made by that party.

## **10 Closing Submissions**

- 10.1 The Chairperson shall allow first, the Responsible Authority/Authorities and any person/s who have made a Relevant Representation to make a closing oral submission(s) and secondly invite the Applicant or the Applicant's Representative an opportunity to make an oral closing submission in support of the Application.

## **11 Decision**

- 11.1 The Committee, the Committee Lawyer and the Committee Manager, shall retire so that the decision may be considered in private, and to consider any legal issues raised by the Members.
- 11.2 The decision, and reasons for the decision, of the Committee shall be communicated orally by the Chairperson to the parties after the Committee has deliberated in private on the Application.
- 11.3 Written reasons shall be provided soon after the deliberations of the Application and in any event within the statutory time limits.

## Hearing Procedure Summary

1. The Democratic Services Officer will request nominations for a Chairman for the Hearing.
2. The Chairperson welcomes all those present and introduces the Application.
3. The Chairperson introduces the members of the Sub Committee and invites all parties present (Applicant, Responsible Authority/Authorities, any person/s who have made a Relevant Representation and Council Officers) to introduce themselves.
4. The Chairperson outlines the Hearing Procedure as set out in the Agenda, makes any relevant announcements and asks for any declarations of interest.
5. The Licensing Officer is asked to present their Committee Report.
6. The Applicant/their representative is invited to address the Sub Committee in support of their application.
7. Questions to the Applicant by Members of the Sub Committee.
8. Questions to the Applicant by Responsible Authority/Authorities and/or any person/s who have made a Relevant Representation which are to be directed through the Chairperson.
9. Any Responsible Authority/Authorities and/or any person/s who have made a Relevant Representation are invited to address the Sub Committee in support of their representations.
10. Questions to the Responsible Authorities/those who have made a Relevant Representation by Members of the Sub Committee.
11. Questions to the Responsible Authorities/those who have made a Relevant Representation by the Applicant, which are to be directed through the Chairperson.
12. Closing submissions by those Parties who have made a Relevant Representation in reverse order.
13. Closing submissions by the Applicant.
14. Sub Committee retires with the Committee Lawyer and Committee Manager to consider its decision.
15. Sub Committee returns and the Lawyer gives a summary of any legal advice that may have been given to the Sub Committee.
16. The Chairperson either gives the decision with reasons, or advises that it will be released in writing with reasons within the statutory time limits (5 working days).

This page is intentionally left blank

## WILTSHIRE COUNCIL

### SOUTHERN AREA LICENSING SUB COMMITTEE

4 January 2018

---

#### Application for a Premises Licence; Mauls Wine & Cheese Bar, 3 Fish Row, Salisbury, Wiltshire, SP1 1EX

#### 1. Purpose of Report

To determine an application for a Premises Licence in respect of licensable activities at Mauls Wine & Cheese Bar, 3 Fish Row, Salisbury, Wiltshire, SP1 1EX

#### 2. Background Information

2.1 An application for a Premises Licence in respect of Mauls Wine & Cheese Bar, 3 Fish Row, Salisbury, Wiltshire, SP1 1EX has been made by mauls Wine & Cheese Bar Ltd.

2.2 During the consultation period 1 letter of objection was received. As set out below, the objection was accepted as being a relevant representation under prevention of Public Nuisance.

2.3 Wiltshire Council (as the Licensing Authority) must hold a hearing to consider the application having regard to the representations. In accordance with Section 18 (3) of The Licensing Act 2003 the Licensing Sub Committee is required to take such of the steps listed in 2.4 below as it considers appropriate for the promotion of the licensing objectives. In considering the application and the relevant representations, the Sub Committee must also have regard to relevant Government guidance and the Council's Licensing Policy

2.4 The licensing objectives are:

- i) The Prevention of Crime and Disorder;
- ii) Public Safety;
- iii) The Prevention of Public Nuisance; and
- iv) The Protection of Children from Harm.

2.5 Such steps are:

- i) To grant the licence subject to such conditions as are consistent with those included in the operating schedule submitted with the application, modified to such extent as the Sub Committee considers appropriate for the promotion of the licensing objectives, together with any mandatory conditions required by the Licensing Act.
- ii) To exclude from the scope of the application any licensable activity.

- iii) To refuse to specify a person as the designated premises supervisor.
- iv) To reject the application.

2.6 On 1st November 2017 an application for a Premises Licence was received and accepted as a valid application..

2.7 The application as applied for is as follows:

Licensable Activity	Timings	Days
<u>Provision of regulated entertainment</u>		
Live music	1100 -2300	Tue - Sun
Recorded music	1100 -2300	Tue - Sun
Sale by retail of alcohol (On the Premises)	1100 -2300	Tue - Sun

2.8 The Legislative Reform (Entertainment Licensing) Order 2014 came into force on 6 April 2015. The 2014 Order has deregulated regulated entertainment in certain situations. This is relevant to this application as the regulated entertainment that has been applied for, depending on the circumstances in which it is held, may not be licensable. Further details on the 2014 Order are attached as **Appendix 1**.

2.9 A copy of the application from Mauls Wine and Cheese Bar is attached as **Appendix 2**.

2.10 A copy of plans of the Licensable area for Mauls Wine and Cheese bar are attached as **Appendix 3**.

2.10 The other premises which are licensed within the vicinity of the application address are detailed as follows:

Premises	Licensed Hours for of Alcohol On Sales and/or Late Night Refreshment	Days
Chikoland, 10 New Canal	23.00 – 03.00 23:00 – 04:00	Sunday - Tuesday Wednesday - Saturday
Nando's 1-5 Milford Street	11:00 – 00:00	Sunday - Saturday
Reeve The Baker, 2 Butcher Row	07.00 – 22.00	Monday – Sunday
York Roast HogRoast Co. 4 Butcher Row	23.00 – 02.00	Friday & Saturday

2.11 A location plan of the premises is attached as **Appendix 4** compared to other Premises mentioned above to this report.

### 3. Consultation and Representations

3.1 The application process requires the application to be advertised, by the Applicant, in a local news publication within 10 working days, starting on the day after the authority receives it and for a public notice (on pale blue paper) to be posted on the premises. In addition the Licensing Authority advertises the application on its website, for a period of 28 consecutive days, starting the day after the authority receives the application.

3.2 During the consultation period no relevant representations were received from Responsible Authorities. 1 relevant representation objecting to the application have been received from local residents.

3.3 During the consultation period the applicant made the following amendments to the application :-

- Front door to be fitted with self-closing units. Doors and windows to be kept closed, except for access and egress after 2000hrs when the premise is open to the public.
- Customers will not be permitted to take opened drinking vessels off the premises.
- Smokers will be asked to move away from the premise/ nearby residential properties to smoke.
- A notice will be prominently placed at the exit requesting customers to leave quietly. Staff will also remind patrons at the end of the evening to leave quietly and be respectful to neighbours to prevent local residents being unduly disturbed by patron noise.

The Environmental Health Team did not make a representation as a result of this being amended and implemented as Premises Licence conditions.

#### 3.4 Representations Received

- Ms Josephine Cetti

3.5 A summary of the representations made is detailed in the table below:

Representation	Licensing Objective	Accepted	Comments
Disturbance caused by customers and music in Premises	Prevention of Public Nuisance	Yes	

3.6 The relevant representations objecting to the application are attached as **Appendix 5**.

### 4. Legal Implications

4.1 This hearing is governed by the Licensing Act 2003 (Hearings) Regulations. These provide that hearings should be held in public unless the Licensing Authority considers that the public interest in excluding the public outweighs the public interest in the hearing taking place in public.

4.2 The Applicant, and all persons who have made relevant representations have been informed of the date, time and location of the hearing and their right to attend and be represented.

4.3 At the hearing all those who have made relevant representations are entitled to address the Sub Committee and to ask questions of another party, with the consent of the Sub Committee.

## **5. Officer Recommendations**

5.1 Officers are not permitted to make a recommendation – the decision is to be reached by the members of the Licensing Sub Committee.

## **6. Right of Appeal**

6.1 It should be noted that the Applicant and those persons who have made relevant representations may appeal the decision made by the Licensing Sub Committee to the Magistrates Court. The appeal must be lodged with the Magistrates Court within 21 days of the notification of the decision.

6.2 In the event of an appeal being lodged, the decision made by the Licensing Sub Committee remains valid until any appeal is heard and any decision made by the Magistrates Court.

6.3 A Responsible Authority or any person may apply to the Licensing Authority for a Review of a Premises Licence. Whether or not a Review Hearing takes place is in the discretion of the Licensing Authority, but, if requested by a person other than a Responsible Authority it will not normally be granted within the first 12 months except for the most compelling circumstances.

---

Report Author: Ian Garrod

Public Protection Officer, Licensing  
01722 432484

Date of report: 30<sup>th</sup> November 2017

### **Background Papers Used in the Preparation of this Report**

- The Licensing Act 2003
- The Licensing Act (Hearings) Regulations 2005
- Guidance issued under Section 182 of the Licensing Act 2003
- Wiltshire Council Licensing Policy

### **Appendices**



- 1. Deregulations – April 2015**
- 2. New Premises Application Form**
- 3. Plans of Premises Licensable area**
- 4. Location plan of the premises**
- 5. Relevant Representation**

This page is intentionally left blank

## Licensing Act 2003 – Entertainment Exemptions

The Legislative Reform (Entertainment Licensing) Order 2014 comes into force on 6 April 2015. This adds a few more exemptions to the Act relating to regulated entertainment.

### **Licence Exemptions:-**

**The following activities no longer require a licence from 6<sup>th</sup> April 2015:-**

#### **Live Music: (no licence required for):-**

- A performance of unamplified live music between 08:00 and 23:00 on any day, on any premises
- A performance of amplified live music between 08:00 and 23:00 on any day on premises licensed to sell alcohol ON the premises, provided that the audience does not exceed 500
- A performance of amplified live music between 08:00 and 23:00 on any day, in a workplace that is not licensed to sell alcohol on the premises, provided that the audience does not exceed 500.
- A performance of amplified live music between 08:00 and 23:00 on any day
  1. In a Church
  2. Village Hall
  3. Community Hall
  4. Or other similar community premises

That is not licensed by a premises licence to sell alcohol provided that the audience does not exceed 500 and the organiser get consent from a person responsible for the premises.

- A performance of amplified live music between 08:00 and 23:00 on any day, at the:-
  1. Non-residential premises
  2. Local authority
  3. School
  4. Hospital

Provided that the organiser gets consent on the relevant premises: the local authority concerned, the school or the health care provider for the hospital.

**Recorded Music: (no licence required for):-**

- Any playing of recorded music between 08:00 and 23:00 on any day on a premises that is licensed to sell alcohol ON the premises, provided that the audience does not exceed 500
- Any playing of recorded music between 08:00 and 23:00 on any day in a:-
  1. Church hall
  2. Village hall
  3. Community hall
  4. Or other similar community premises

That is not licensed by a premises licence to sell alcohol provided that the audience does not exceed 500 and the organiser get consent from a person responsible for the premises.

- Any playing of recorded music between 08:00 and 23:00 on any day, at the:-
  5. Non-residential premises
  6. Local authority
  7. School
  8. Hospital

Provided that the organiser gets consent on the relevant premises; the local authority concerned, the school or the health care provider for the hospital.

**Plays:-**

- Performances between 08:00 and 23:00 on any day, provided that the audience does not exceed 500

**Dance:-**

- Performances between 08:00 and 23:00 on any day provided that the audience does not exceed 500

**Films:-**

- a “not-for-profit” film exhibition held in a community premises between 08:00 – 23:00 on any day provided that the audience does not exceed 500 and the organiser gets consent from a person responsible for the premises and ensures that such screening abides by age classification ratings.

**Indoor sporting event:-**

- an event that takes place between 08:00 and 23:00 on any day provided that those present do not exceed 1000.

### **Boxing or Wrestling entertainment:-**

- a contest, exhibition or display of Greco-Roman wrestling, or freestyle wrestling between 08:00 – 23:00 on any day, provided that the audience does not exceed 1000.

### **Cross activity exemptions; no licence is required between 08:00 and 23:00 on any day, with no limit on audience size for:-**

- any entertainment taking place on the premises of the local authority where the entertainment is provided by or on behalf of the local authority
- any entertainment taking place on the hospital premises of the health care provider where the entertainment is provided by or on behalf of the health care provider
- any entertainment taking place on the premises of the school where the entertainment is provided by or on behalf of the school proprietor
- any entertainment (excluding films and a boxing or wrestling entertainment) taking place at a travelling circus, provided that:-
  1. it takes place within moveable structure that accommodates the audience
  2. that the travelling circus has not been located on the same site for more than 28 consecutive days.

**Any activities that takes place before 08:00 or after 23:00 will require either a premises licence or a Temporary Event Notice.**

### **Other Deregulations**

#### **Personal licence renewals**

The requirement to renew a personal licence has now been abolished with effect from 1st April 2015. Personal Licences will remain in effect continuously unless surrendered or revoked.

#### **Sale of liqueur confectionery to children under 16: abolition of offence**

The Deregulation Act has abolished the offence of selling liquor confectionary to children under 16 with effect from 26th May 2015, after that date, a person of any age can purchase liquor confectionary (Chocolate Liquors) in England and Wales

### **Requirement to report lost or stolen licences**

The requirement to report lost or stolen licences to the police before applying for a duplicate licence has been abolished with effect from 26th May 2015

### **Temporary Event Notices**

The limit on the number of temporary events that can be held at a premise will be increased from 12 to 15 per year with effect from 1st January 2016. This is unlikely to have any adverse impact on the workload of Licensing Officers and an insignificant impact on income.

# Wiltshire Council

Where everybody matters

**Application for a premises licence to be granted  
under the Licensing Act 2003**

**PLEASE READ THE FOLLOWING INSTRUCTIONS FIRST**

Before completing this form please read the guidance notes at the end of the form. If you are completing this form by hand please write legibly in block capitals. In all cases ensure that your answers are inside the boxes and written in black ink. Use additional sheets if necessary.

You may wish to keep a copy of the completed form for your records.

**I/We** MAULS WINE AND CHEESE BAR LTD  
*(Insert name(s) of applicant)*

**apply for a premises licence under section 17 of the Licensing Act 2003 for the premises described in Part 1 below (the premises) and I/we are making this application to you as the relevant licensing authority in accordance with section 12 of the Licensing Act 2003**

**Part 1 – Premises details**

Postal address of premises or, if none, ordnance survey map reference or description <u>MAULS WINE AND CHEESE BAR LTD</u> <u>3 FISH ROW</u>			
<b>Post town</b>	<u>SALISBURY</u>	<b>Postcode</b>	<u>SP1 1EX</u>
<b>Telephone number at premises (if any)</b>		<u>N/A</u>	
<b>Non-domestic rateable value of premises</b>		<u>£ 20,250</u>	

**Part 2 - Applicant details**

Please state whether you are applying for a premises licence as Please tick as appropriate

- |   |                                     |                             |
|---|-------------------------------------|-----------------------------|
| a) an individual or individuals *                     | <input type="checkbox"/>            | please complete section (A) |
| b) a person other than an individual *                |                                     |                             |
| i) as a limited company/limited liability partnership | <input checked="" type="checkbox"/> | please complete section (B) |
| ii) as a partnership (other than limited liability)   | <input type="checkbox"/>            | please complete section (B) |
| iii) as an unincorporated association or              | <input type="checkbox"/>            | please complete section (B) |
| iv) other (for example a statutory corporation)       | <input type="checkbox"/>            | please complete section (B) |

- c) a recognised club  please complete section (B)
- d) a charity  please complete section (B)
- e) the proprietor of an educational establishment  please complete section (B)
- f) a health service body  please complete section (B)
- g) a person who is registered under Part 2 of the Care Standards Act 2000 (c14) in respect of an independent hospital in Wales  please complete section (B)
- ga) a person who is registered under Chapter 2 of Part 1 of the Health and Social Care Act 2008 (within the meaning of that Part) in an independent hospital in England  please complete section (B)
- h) the chief officer of police of a police force in England and Wales  please complete section (B)

\* If you are applying as a person described in (a) or (b) please confirm (by ticking yes to one box below):

- I am carrying on or proposing to carry on a business which involves the use of the premises for licensable activities; or
- I am making the application pursuant to a
  - statutory function or
  - a function discharged by virtue of Her Majesty's prerogative

**(A) INDIVIDUAL APPLICANTS** (fill in as applicable)

<b>Mr</b> <input type="checkbox"/>	<b>Mrs</b> <input type="checkbox"/>	<b>Miss</b> <input type="checkbox"/>	<b>Ms</b> <input type="checkbox"/>	<b>Other Title</b> (for example, Rev)	
<b>Surname</b>			<b>First names</b>		
<b>Date of birth</b>		I am 18 years old or over <input type="checkbox"/>		Please tick yes	
<b>Nationality</b>					
Current residential address if different from premises address					
<b>Post town</b>				<b>Postcode</b>	
<b>Daytime contact telephone number</b>					
<b>E-mail address (optional)</b>					



**SECOND INDIVIDUAL APPLICANT (if applicable)**

Mr <input type="checkbox"/>	Mrs <input type="checkbox"/>	Miss <input type="checkbox"/>	Ms <input type="checkbox"/>	Other Title (for example, Rev)	
Surname			First names		
Date of birth		I am 18 years old or over		<input type="checkbox"/> Please tick yes	
Nationality					
Current postal address if different from premises address					
Post town				Postcode	
Daytime contact telephone number					
E-mail address (optional)					

**(B) OTHER APPLICANTS**

Please provide name and registered address of applicant in full. Where appropriate please give any registered number. In the case of a partnership or other joint venture (other than a body corporate), please give the name and address of each party concerned.

Name	MAULS WINE AND CHEESE BAR LTD
Address	9 Greenfields west GRIMSTEAD SALISBURY WILTSHIRE, SP5 3SH
Registered number (where applicable)	10965201
Description of applicant (for example, partnership, company, unincorporated association etc.)	LTD COMPANY
Telephone number (if any)	
E-mail address (optional)	accounts@maulswinebar.com

**Part 3 Operating Schedule**

When do you want the premises licence to start?

DD	MM	YYYY
01	12	2017

If you wish the licence to be valid only for a limited period, when do you want it to end?

DD	MM	YYYY

Please give a general description of the premises (please read guidance note 1)  
 Location = 3 Fish Row. Grade II Listed building with 2 Floors which holds A1 (retail) and A3 (restaurant + cafe) uses. Situated between Queen Street and Butcher Row. There are two entrances but only one will be open to the public and all sales will be sold indoors only. Consumption will be indoors only.

If 5,000 or more people are expected to attend the premises at any one time, please state the number expected to attend.

What licensable activities do you intend to carry on from the premises?

(please see sections 1 and 14 and Schedules 1 and 2 to the Licensing Act 2003)

Provision of regulated entertainment (please read guidance note 2)

Please tick all that apply

- a) plays (if ticking yes, fill in box A)
- b) films (if ticking yes, fill in box B)
- c) indoor sporting events (if ticking yes, fill in box C)
- d) boxing or wrestling entertainment (if ticking yes, fill in box D)
- e) live music (if ticking yes, fill in box E)
- f) recorded music (if ticking yes, fill in box F)
- g) performances of dance (if ticking yes, fill in box G)
- h) anything of a similar description to that falling within (e), (f) or (g) (if ticking yes, fill in box H)

Provision of late night refreshment (if ticking yes, fill in box I)

Supply of alcohol (if ticking yes, fill in box J)

**In all cases complete boxes K, L and M**

**A**

Plays Standard days and timings (please read guidance note 7)			<b>Will the performance of a play take place indoors or outdoors or both – please tick</b> (please read guidance note 3)	Indoors	<input type="checkbox"/>
Day	Start	Finish		Outdoors	<input type="checkbox"/>
				Both	<input type="checkbox"/>
Mon			<b>Please give further details here</b> (please read guidance note 4)		
Tue			<b>State any seasonal variations for performing plays</b> (please read guidance note 5)		
Wed			<b>Non standard timings. Where you intend to use the premises for the performance of plays at different times to those listed in the column on the left, please list</b> (please read guidance note 6)		
Thur					
Fri					
Sat					
Sun					

**B**

<b>Films</b> Standard days and timings (please read guidance note 7)			<b><u>Will the exhibition of films take place indoors or outdoors or both – please tick</u></b> (please read guidance note 3)	Indoors	<input type="checkbox"/>			
				Outdoors	<input type="checkbox"/>			
Both	<input type="checkbox"/>							
Day	Start	Finish	<b><u>Please give further details here</u></b> (please read guidance note 4)					
Mon								
Tue								
Wed						<b><u>State any seasonal variations for the exhibition of films</u></b> (please read guidance note 5)		
Thur								
Fri						<b><u>Non standard timings. Where you intend to use the premises for the exhibition of films at different times to those listed in the column on the left, please list</u></b> (please read guidance note 6)		
Sat								
Sun								

C

<b>Indoor sporting events</b> Standard days and timings (please read guidance note 7)			<b><u>Please give further details</u></b> (please read guidance note 4)
Day	Start	Finish	
Mon			
Tue			<b><u>State any seasonal variations for indoor sporting events</u></b> (please read guidance note 5)
Wed			
Thur			<b><u>Non standard timings. Where you intend to use the premises for indoor sporting events at different times to those listed in the column on the left, please list</u></b> (please read guidance note 6)
Fri			
Sat			
Sun			

**D**

<b>Boxing or wrestling entertainments</b> Standard days and timings (please read guidance note 7)			<b>Will the boxing or wrestling entertainment take place indoors or outdoors or both – please tick</b> (please read guidance note 3)	Indoors	<input type="checkbox"/>
				Outdoors	<input type="checkbox"/>
Day	Start	Finish		Both	<input type="checkbox"/>
Mon			<b>Please give further details here</b> (please read guidance note 4)		
Tue					
Wed			<b>State any seasonal variations for boxing or wrestling entertainment</b> (please read guidance note 5)		
Thur					
Fri			<b>Non standard timings. Where you intend to use the premises for boxing or wrestling entertainment at different times to those listed in the column on the left, please list</b> (please read guidance note 6)		
Sat					
Sun					

**E**

Live music Standard days and timings (please read guidance note 7)			Will the performance of live music take place <u>indoors or outdoors or both – please tick</u> (please read guidance note 3)	Indoors	<input checked="" type="checkbox"/>
Day	Start	Finish		Outdoors	<input type="checkbox"/>
Mon	closed	closed	<b><u>Please give further details here</u></b> (please read guidance note 4)	Both	<input type="checkbox"/>
Tue	11:00	23:00			
Wed	11:00	23:00	<b><u>State any seasonal variations for the performance of live music</u></b> (please read guidance note 5)		
Thur	11:00	23:00			
Fri	11:00	23:00	<b><u>Non standard timings. Where you intend to use the premises for the performance of live music at different times to those listed in the column on the left, please list</u></b> (please read guidance note 6)		
Sat	11:00	23:00			
Sun	11:00	23:00			



**I**

Late night refreshment Standard days and timings (please read guidance note 7)			Will the provision of late night refreshment take place indoors or outdoors or both – please tick (please read guidance note 3)	Indoors	<input type="checkbox"/>
Day	Start	Finish		Outdoors	<input type="checkbox"/>
Mon			<b><u>Please give further details here</u></b> (please read guidance note 4)	Both	<input type="checkbox"/>
Tue					
Wed			<b><u>State any seasonal variations for the provision of late night refreshment</u></b> (please read guidance note 5)		
Thur					
Fri			<b><u>Non standard timings. Where you intend to use the premises for the provision of late night refreshment at different times, to those listed in the column on the left, please list</u></b> (please read guidance note 6)		
Sat					
Sun					

# H

<b>Anything of a similar description to that falling within (e), (f) or (g)</b> Standard days and timings (please read guidance note 7)			Please give a description of the type of entertainment you will be providing		
Day	Start	Finish	<b><u>Will this entertainment take place indoors or outdoors or both – please tick</u></b> (please read guidance note 3)	Indoors	<input type="checkbox"/>
Mon				Outdoors	<input type="checkbox"/>
				Both	<input type="checkbox"/>
Tue			<b><u>Please give further details here</u></b> (please read guidance note 4)		
Wed					
Thur			<b><u>State any seasonal variations for entertainment of a similar description to that falling within (e), (f) or (g)</u></b> (please read guidance note 5)		
Fri					
Sat			<b><u>Non standard timings. Where you intend to use the premises for the entertainment of a similar description to that falling within (e), (f) or (g) at different times to those listed in the column on the left, please list</u></b> (please read guidance note 6)		
Sun					

**G**

<b>Performances of dance</b> Standard days and timings (please read guidance note 7)			<b>Will the performance of dance take place indoors or outdoors or both – please tick</b> (please read guidance note 3)	Indoors	<input type="checkbox"/>
				Outdoors	<input type="checkbox"/>
				Both	<input type="checkbox"/>
<b>Day</b>	<b>Start</b>	<b>Finish</b>	<b><u>Please give further details here</u></b> (please read guidance note 4)		
Mon					
Tue					
			<b><u>State any seasonal variations for the performance of dance</u></b> (please read guidance note 5)		
Wed					
Thur					
			<b><u>Non standard timings. Where you intend to use the premises for the performance of dance at different times to those listed in the column on the left, please list</u></b> (please read guidance note 6)		
Fri					
Sat					
Sun					

**F**

Recorded music Standard days and timings (please read guidance note 7)			Will the playing of recorded music take place <u>indoors or outdoors or both – please tick</u> (please read guidance note 3)	Indoors	<input checked="" type="checkbox"/>
Day	Start	Finish		Outdoors	<input type="checkbox"/>
Mon	closed	closed	<b><u>Please give further details here</u></b> (please read guidance note 4)	Both	<input type="checkbox"/>
Tue	11:00	23:00			
Wed	11:00	23:00	<b><u>State any seasonal variations for the playing of recorded music</u></b> (please read guidance note 5)		
Thur	11:00	23:00			
Fri	11:00	23:00	<b><u>Non standard timings. Where you intend to use the premises for the playing of recorded music at different times to those listed in the column on the left, please list</u></b> (please read guidance note 6)		
Sat	11:00	23:00			
Sun	11:00	23:00			

**J**

<b>Supply of alcohol</b> Standard days and timings (please read guidance note 7)			<b>Will the supply of alcohol be for consumption</b> — please tick (please read guidance note 8)	On the premises	<input checked="" type="checkbox"/>
				Off the premises	<input type="checkbox"/>
				Both	<input type="checkbox"/>
Day	Start	Finish	<b>State any seasonal variations for the supply of alcohol</b> (please read guidance note 5)		
Mon	closed	closed			
Tue	11:00	23:00			
Wed	11:00	23:00			
Thur	11:00	23:00			
Fri	11:00	23:00			
Sat	11:00	23:00			
Sun	11:00	23:00			

State the name and details of the individual whom you wish to specify on the licence as designated premises supervisor (Please see declaration about the entitlement to work in the checklist at the end of the form):

Name	ANDREW ROBERT MAUL
Date of birth	[REDACTED]
Address	[REDACTED]
Postcode	[REDACTED]
Personal licence number (if known)	LN / 0013811
Issuing licensing authority (if known)	wiltshire Council

K

Please highlight any adult entertainment or services, activities, other entertainment or matters ancillary to the use of the premises that may give rise to concern in respect of children (please read guidance note 9).

N/A

L

Hours premises are open to the public Standard days and timings (please read guidance note 7)			State any seasonal variations (please read guidance note 5)
Day	Start	Finish	
Mon	Closed	Closed	<p><b>Non standard timings. Where you intend the premises to be open to the public at different times from those listed in the column on the left, please list</b> (please read guidance note 6)</p>
Tue	11:00	23:00	
Wed	11:00	23:00	
Thur	11:00	23:00	
Fri	11:00	23:00	
Sat	11:00	23:00	
Sun	11:00	23:00	

**M** Describe the steps you intend to take to promote the four licensing objectives:

**a) General – all four licensing objectives (b, c, d and e) (please read guidance note 10)**

- Recorded training every quarter + Yearly using an External training company and keep signed records = this on alcohol and health and safety
- Challenge 25 all customers and record using till button for auditing
- encourage sensible drinking and using special promotions to reward drinkers, also offer cab booking service for customers
- Signage stating drinks cannot be removed from site, where to smoke, and to respect neighbours in later hours.

**b) The prevention of crime and disorder**

CCTV to be installed with cameras covering both external doors, bar area, upstairs and where stock is stored. All staff to be trained on using CCTV and images to be kept for a max of 30 days and to be provided to authorities upon request. Prevent crime by working with police and other bars + Pubs to ban offenders. Staff to deal with drunks by - Stop serving immediately  
• offer the customer coffee and food • Call a cab or ride for customer • or if they become angry, escort offsite and call the police.

**c) Public safety**

Limit numbers to the upstairs at premises, by placing a member of staff upstairs controlling numbers. Train staff using online course from virtual college on Health and safety. No glasses to be removed from premises and signs put up indicating this. Ban offenders and work with the local police and other bars, pubs to ban any offenders that cause issues in the area.

**d) The prevention of public nuisance**

During busy times more staff to be on hand. Notices on door to advise customers to be respectful upon exiting. Notices also advising on smoking outside the premises and where to smoke. Smoking bin to be provided. Towards the end of the night, reduce music levels. Door to bar to be closed after 8pm to reduce noise levels.

**e) The protection of children from harm**

we will have a challenge 25 notice behind the bar, stating we will only accept photo driving licence or passport. we will only allow under 18's into the bar before 7pm unless with an adult and after, if a table booking is made and with an adult. we will stop any under 18's entering the bar on certain events regardless (example NYE) training provided to staff every quarter plus yearly with outside training company - signed records to be kept.

**Checklist:**

**Please tick to indicate agreement**

- I have made or enclosed payment of the fee.
- I have enclosed the plan of the premises.
- I have sent copies of this application and the plan to responsible authorities and others where applicable.
- I have enclosed the consent form completed by the individual I wish to be designated premises supervisor, if applicable.
- I understand that I must now advertise my application.
- I understand that if I do not comply with the above requirements my application will be rejected.
- [Applicable to all individual applicants, including those in a partnership which is not a limited liability partnership, but not companies or limited liability partnerships] I have included documents demonstrating my entitlement to work in the United Kingdom (please read note 15).

**IT IS AN OFFENCE, UNDER SECTION 158 OF THE LICENSING ACT 2003, TO MAKE A FALSE STATEMENT IN OR IN CONNECTION WITH THIS APPLICATION. THOSE WHO MAKE A FALSE STATEMENT MAY BE LIABLE ON SUMMARY CONVICTION TO A FINE OF ANY AMOUNT.**

**IT IS AN OFFENCE UNDER SECTION 24B OF THE IMMIGRATION ACT 1971 FOR A PERSON TO WORK WHEN THEY KNOW, OR HAVE REASONABLE CAUSE TO BELIEVE, THAT THEY ARE DISQUALIFIED FROM DOING SO BY REASON OF THEIR IMMIGRATION STATUS. THOSE WHO EMPLOY AN ADULT WITHOUT LEAVE OR WHO IS SUBJECT TO CONDITIONS AS TO EMPLOYMENT WILL BE LIABLE TO A CIVIL PENALTY UNDER SECTION 15 OF THE IMMIGRATION, ASYLUM AND NATIONALITY ACT 2006 AND PURSUANT TO SECTION 21 OF THE SAME ACT, WILL BE COMMITTING AN OFFENCE WHERE THEY DO SO IN THE KNOWLEDGE, OR WITH REASONABLE CAUSE TO BELIEVE, THAT THE EMPLOYEE IS DISQUALIFIED.**

**Part 4 – Signatures** (please read guidance note 11)

**Signature of applicant or applicant’s solicitor or other duly authorised agent** (see guidance note 12). **If signing on behalf of the applicant, please state in what capacity.**

<b>Declaration</b>	<ul style="list-style-type: none"> <li>• [Applicable to individual applicants only, including those in a partnership which is not a limited liability partnership] I understand I am not entitled to be issued with a licence if I do not have the entitlement to live and work in the UK (or if I am subject to a condition preventing me from doing work relating to the carrying on of a licensable activity) and that my licence will become invalid if I cease to be entitled to live and work in the UK (please read guidance note 15).</li> <li>• The DPS named in this application form is entitled to work in the UK</li> </ul>
--------------------	--



	(and is not subject to conditions preventing him or her from doing work relating to a licensable activity) and I have seen a copy of his or her proof of entitlement to work, if appropriate (please see note 15)
Signature	[REDACTED]
Date	31/10/17
Capacity	DIRECTOR

**For joint applications, signature of 2<sup>nd</sup> applicant or 2<sup>nd</sup> applicant's solicitor or other authorised agent (please read guidance note 13). If signing on behalf of the applicant, please state in what capacity.**

Signature	
Date	
Capacity	

Contact name (where not previously given) and postal address for correspondence associated with this application (please read guidance note 14)			
ANDREW MAUL			
[REDACTED]			
[REDACTED]			
Post town	[REDACTED]	Postcode	[REDACTED]
Telephone number (if any)	[REDACTED]		
If you would prefer us to correspond with you by e-mail, your e-mail address (optional)			
accounts@maulswinebar.com			

**Notes for Guidance**

1. Describe the premises, for example the type of premises, its general situation and layout and any other information which could be relevant to the licensing objectives. Where your application includes off-supplies of alcohol and you intend to provide a place for consumption of these off-supplies, you must include a description of where the place will be and its proximity to the premises.
2. In terms of specific regulated entertainments please note that:
  - Plays: no licence is required for performances between 08:00 and 23.00 on any day, provided that the audience does not exceed 500.
  - Films: no licence is required for 'not-for-profit' film exhibition held in community premises between 08.00 and 23.00 on any day provided that the audience does not exceed 500 and the organiser (a) gets consent to the screening from a person who is responsible for the premises; and (b) ensures that each such screening abides by age classification ratings.
  - Indoor sporting events: no licence is required for performances between 08.00 and 23.00 on any day, provided that the audience does not exceed 1000.

- Boxing or Wrestling Entertainment: no licence is required for a contest, exhibition or display of Greco-Roman wrestling, or freestyle wrestling between 08.00 and 23.00 on any day, provided that the audience does not exceed 1000. Combined fighting sports – defined as a contest, exhibition or display which combines boxing or wrestling with one or more martial arts – are licensable as a boxing or wrestling entertainment rather than an indoor sporting event.
- Live music: no licence permission is required for:
  - a performance of unamplified live music between 08.00 and 23.00 on any day, on any premises.
  - a performance of amplified live music between 08.00 and 23.00 on any day on premises authorised to sell alcohol for consumption on those premises, provided that the audience does not exceed 500.
  - a performance of amplified live music between 08.00 and 23.00 on any day, in a workplace that is not licensed to sell alcohol on those premises, provided that the audience does not exceed 500.
  - a performance of amplified live music between 08.00 and 23.00 on any day, in a church hall, village hall, community hall, or other similar community premises, that is not licensed by a premises licence to sell alcohol, provided that (a) the audience does not exceed 500, and (b) the organiser gets consent for the performance from a person who is responsible for the premises.
  - a performance of amplified live music between 08.00 and 23.00 on any day, at the non-residential premises of (i) a local authority, or (ii) a school, or (iii) a hospital, provided that (a) the audience does not exceed 500, and (b) the organiser gets consent for the performance on the relevant premises from: (i) the local authority concerned, or (ii) the school or (iii) the health care provider for the hospital.
- Recorded Music: no licence permission is required for:
  - any playing of recorded music between 08.00 and 23.00 on any day on premises authorised to sell alcohol for consumption on those premises, provided that the audience does not exceed 500.
  - any playing of recorded music between 08.00 and 23.00 on any day, in a church hall, village hall, community hall, or other similar community premises, that is not licensed by a premises licence to sell alcohol, provided that (a) the audience does not exceed 500, and (b) the organiser gets consent for the performance from a person who is responsible for the premises.
  - any playing of recorded music between 08.00 and 23.00 on any day, at the non-residential premises of (i) a local authority, or (ii) a school, or (iii) a hospital, provided that (a) the audience does not exceed 500, and (b) the organiser gets consent for the performance on the relevant premises from: (i) the local authority concerned, or (ii) the school proprietor or (iii) the health care provider for the hospital.
- Dance: no licence is required for performances between 08.00 and 23.00 on any day, provided that the audience does not exceed 500. However, a performance which amounts to adult entertainment remains licensable.
- Cross activity exemptions: no licence is required between 08.00 and 23.00 on any day, with no limit on audience size for:
  - any entertainment taking place on the premises of the local authority where the entertainment is provided by or on behalf of the local authority;
  - any entertainment taking place on the hospital premises of the health care provider where the entertainment is provided by or on behalf of the health care provider;
  - any entertainment taking place on the premises of the school where the entertainment is provided by or on behalf of the school proprietor; and

- any entertainment (excluding films and a boxing or wrestling entertainment) taking place at a travelling circus, provided that (a) it takes place within a moveable structure that accommodates the audience, and (b) that the travelling circus has not been located on the same site for more than 28 consecutive days.
3. Where taking place in a building or other structure please tick as appropriate (indoors may include a tent).
  4. For example the type of activity to be authorised, if not already stated, and give relevant further details, for example (but not exclusively) whether or not music will be amplified or unamplified.
  5. For example (but not exclusively), where the activity will occur on additional days during the summer months.
  6. For example (but not exclusively), where you wish the activity to go on longer on a particular day e.g. Christmas Eve.
  7. Please give timings in 24 hour clock (e.g. 16.00) and only give details for the days of the week when you intend the premises to be used for the activity.
  8. If you wish people to be able to consume alcohol on the premises, please tick 'on the premises'. If you wish people to be able to purchase alcohol to consume away from the premises, please tick 'off the premises'. If you wish people to be able to do both, please tick 'both'.
  9. Please give information about anything intended to occur at the premises or ancillary to the use of the premises which may give rise to concern in respect of children, regardless of whether you intend children to have access to the premises, for example (but not exclusively) nudity or semi-nudity, films for restricted age groups or the presence of gaming machines.
  10. Please list here steps you will take to promote all four licensing objectives together.
  11. The application form must be signed.
  12. An applicant's agent (for example solicitor) may sign the form on their behalf provided that they have actual authority to do so.
  13. Where there is more than one applicant, each of the applicants or their respective agent must sign the application form.
  14. This is the address which we shall use to correspond with you about this application.

**15. Entitlement to work/immigration status for individual applicants and applications from partnerships which are not limited liability partnerships:**

A licence may not be held by an individual or an individual in a partnership who is resident in the UK who:

- does not have the right to live and work in the UK; or
- is subject to a condition preventing him or her from doing work relating to the carrying on of a licensable activity.

Any premises licence issued in respect of an application made on or after 6 April 2017 will become invalid if the holder ceases to be entitled to work in the UK.

Applicants must demonstrate that they have an entitlement to work in the UK and are not subject to a condition preventing them from doing work relating to the carrying on of a licensable activity. They do this by providing with this application copies or scanned copies of the following documents (which do not need to be certified).

**Documents which demonstrate entitlement to work in the UK**

- An expired or current passport showing the holder, or a person named in the passport as the child of the holder, is a British citizen or a citizen of the UK and Colonies having the right of abode in the UK [please see note below about which sections of the passport to copy].

- An expired or current passport or national identity card showing the holder, or a person named in the passport as the child of the holder, is a national of a European Economic Area country or Switzerland.
- A Registration Certificate or document certifying permanent residence issued by the Home Office to a national of a European Economic Area country or Switzerland.
- A Permanent Residence Card issued by the Home Office to the family member of a national of a European Economic Area country or Switzerland.
- A **current** Biometric Immigration Document (Biometric Residence Permit) issued by the Home Office to the holder indicating that the person named is allowed to stay indefinitely in the UK, or has no time limit on their stay in the UK.
- A **current** passport endorsed to show that the holder is exempt from immigration control, is allowed to stay indefinitely in the UK, has the right of abode in the UK, or has no time limit on their stay in the UK.
- A **current** Immigration Status Document issued by the Home Office to the holder with an endorsement indicating that the named person is allowed to stay indefinitely in the UK or has no time limit on their stay in the UK, **when produced in combination with** an official document giving the person's permanent National Insurance number and their name issued by a Government agency or a previous employer.
- A **full** birth or adoption certificate issued in the UK which includes the name(s) of at least one of the holder's parents or adoptive parents, **when produced in combination with** an official document giving the person's permanent National Insurance number and their name issued by a Government agency or a previous employer.
- A birth or adoption certificate issued in the Channel Islands, the Isle of Man or Ireland **when produced in combination with** an official document giving the person's permanent National Insurance number and their name issued by a Government agency or a previous employer.
- A certificate of registration or naturalisation as a British citizen, **when produced in combination with** an official document giving the person's permanent National Insurance number and their name issued by a Government agency or a previous employer.
- A **current** passport endorsed to show that the holder is allowed to stay in the UK and is currently allowed to work and is not subject to a condition preventing the holder from doing work relating to the carrying on of a licensable activity.
- A **current** Biometric Immigration Document (Biometric Residence Permit) issued by the Home Office to the holder which indicates that the named person can currently stay in the UK and is allowed to work relation to the carrying on of a licensable activity.
- A **current** Residence Card issued by the Home Office to a person who is not a national of a European Economic Area state or Switzerland but who is a family member of such a national or who has derivative rights or residence.

- A **current** Immigration Status Document containing a photograph issued by the Home Office to the holder with an endorsement indicating that the named person may stay in the UK, and is allowed to work and is not subject to a condition preventing the holder from doing work relating to the carrying on of a licensable activity **when produced in combination with** an official document giving the person's permanent National Insurance number and their name issued by a Government agency or a previous employer.
- A Certificate of Application, **less than 6 months old**, issued by the Home Office under regulation 17(3) or 18A (2) of the Immigration (European Economic Area) Regulations 2006, to a person who is not a national of a European Economic Area state or Switzerland but who is a family member of such a national or who has derivative rights of residence.
- Reasonable evidence that the person has an outstanding application to vary their permission to be in the UK with the Home Office such as the Home Office acknowledgement letter or proof of postage evidence, or reasonable evidence that the person has an appeal or administrative review pending on an immigration decision, such as an appeal or administrative review reference number.
- Reasonable evidence that a person who is not a national of a European Economic Area state or Switzerland but who is a family member of such a national or who has derivative rights of residence in exercising treaty rights in the UK including:-
  - evidence of the applicant's own identity – such as a passport,
  - evidence of their relationship with the European Economic Area family member – e.g. a marriage certificate, civil partnership certificate or birth certificate, and
  - evidence that the European Economic Area national has a right of permanent residence in the UK or is one of the following if they have been in the UK for more than 3 months:
    - (i) working e.g. employment contract, wage slips, letter from the employer,
    - (ii) self-employed e.g. contracts, invoices, or audited accounts with a bank,
    - (iii) studying e.g. letter from the school, college or university and evidence of sufficient funds; or
    - (iv) self-sufficient e.g. bank statements.

Family members of European Economic Area nationals who are studying or financially independent must also provide evidence that the European Economic Area national and any family members hold comprehensive sickness insurance in the UK. This can include a private medical insurance policy, an EHIC card or an S1, S2 or S3 form.

**Original documents must not be sent to licensing authorities.** If the document copied is a passport, a copy of the following pages should be provided:-

- (i) any page containing the holder's personal details including nationality;
- (ii) any page containing the holder's photograph;
- (iii) any page containing the holder's signature;
- (iv) any page containing the date of expiry; and
- (v) any page containing information indicating the holder has permission to enter or remain in the UK and is permitted to work.

If the document is not a passport, a copy of the whole document should be provided.

Your right to work will be checked as part of your licensing application and this could involve us checking your immigration status with the Home Office. We may otherwise share information

with the Home Office. Your licence application will not be determined until you have complied with this guidance.

## Consent of individual to being specified as premises supervisor

I ANDREW ROBERT MAUL

*[full name of prospective premises supervisor]*

of



*[home address of prospective premises supervisor]*

hereby confirm that I give my consent to be specified as the designated premises supervisor in relation to the application for

MAULS wine and cheese BAR Ltd

*[type of application]*

by

ANDREW ROBERT MAUL

*[name of applicant]*

relating to a premises licence

*[number of existing licence, if any]*

for

3 Fish Row, SALISBURY, SP1 1EX

*[name and address of premises to which the application relates]*

and any premises licence to be granted or varied in respect of this application made by

MAULS WINE AND CHEESE BAR LTD

*[name of applicant]*

concerning the supply of alcohol at

3 FISH ROW, SALISBURY, SP1 2EX

*[name and address of premises to which application relates]*

I also confirm that I am entitled to work in the United Kingdom and am applying for, intend to apply for or currently hold a personal licence, details of which I set out below.

Personal licence number

10965201

*[insert personal licence number, if any]*

Personal licence issuing authority

WILTSHIRE COUNCIL

*[insert name and address, telephone number of personal licence issuing authority, if any]*

Signed

Name (please print)

ANDREW MAUL

Date

30/10/17



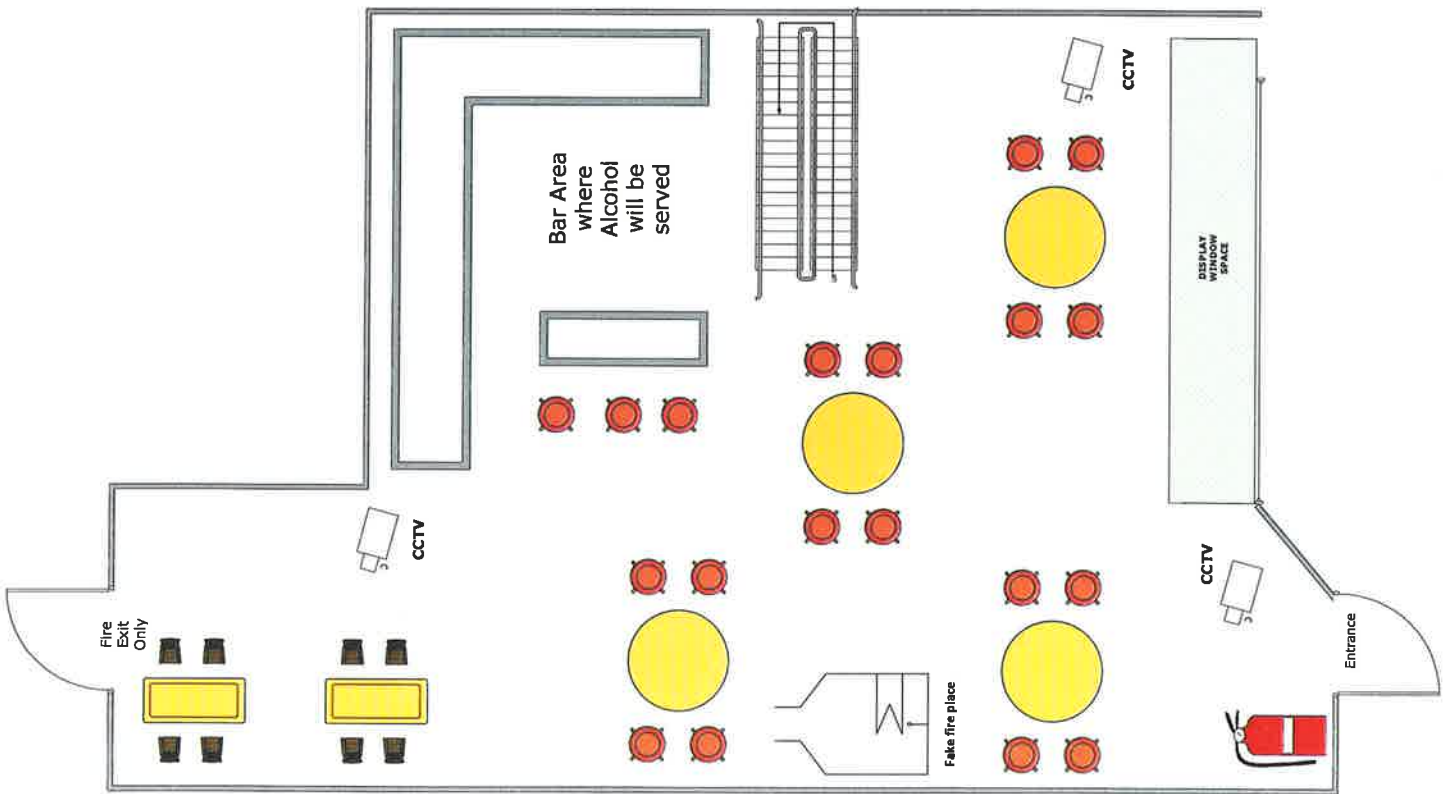

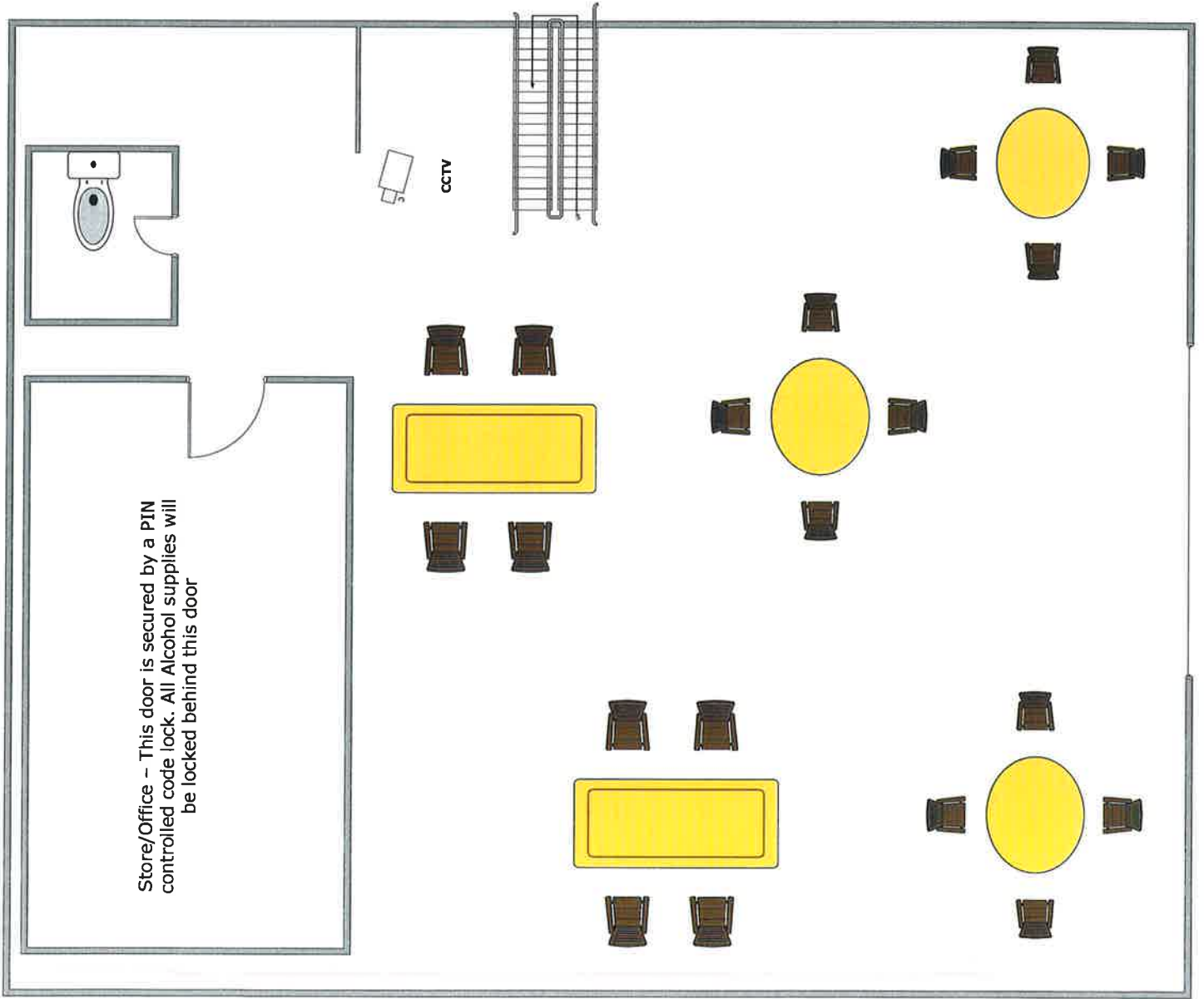

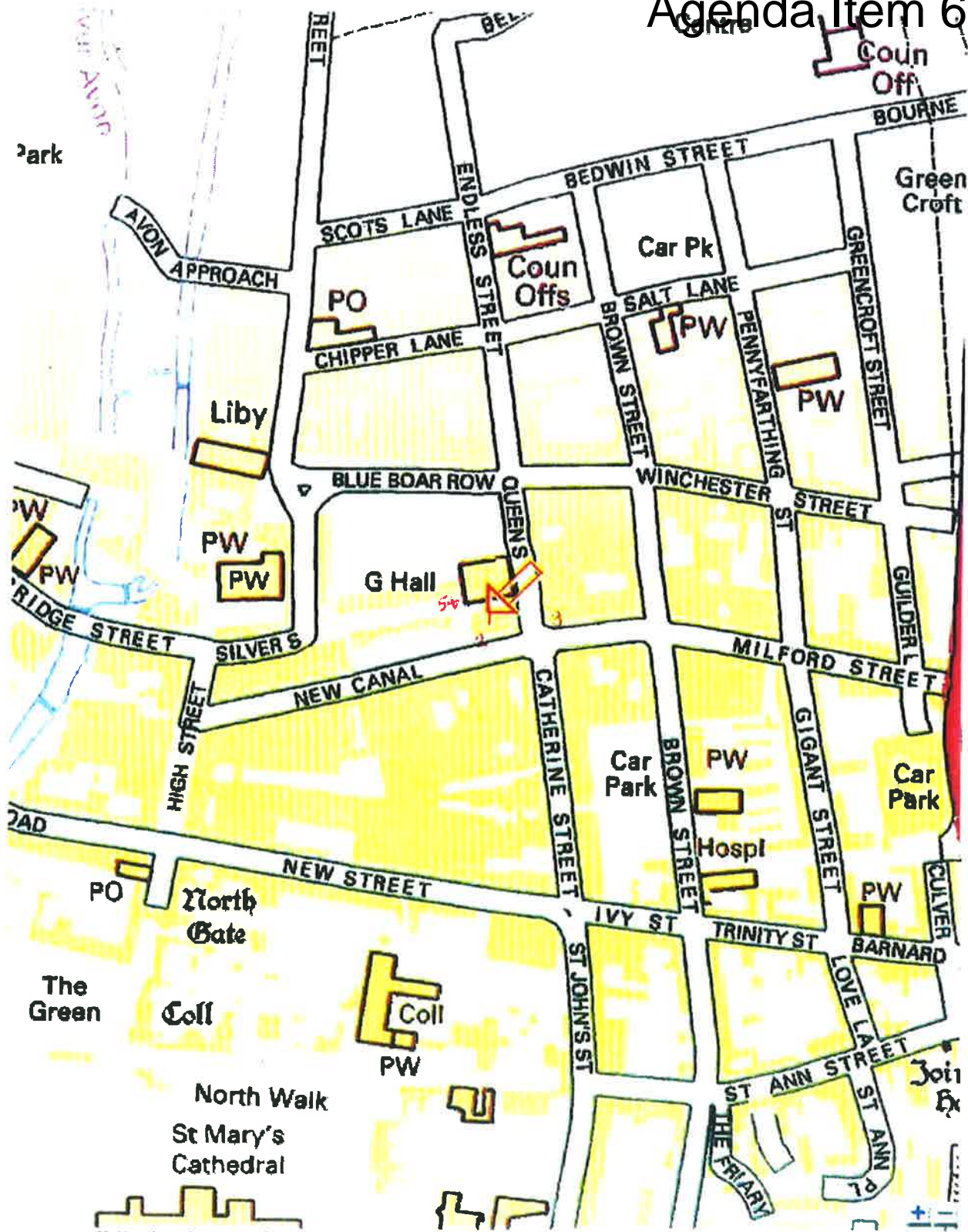

- 1 MAULS
- 2 CHIKOLAND
- 3 NINDOS
- 4 RELVE
- 5 YORK ROAST

This page is intentionally left blank

[REDACTED]  
Salisbury, [REDACTED]

19<sup>th</sup> November 2017

The Licensing Officer  
Licensing Department  
Wiltshire Council  
Monkton Park  
Chippenham, SN15 1ER

Dear Sir/Madam,

**Application: WK/201726719 Maul's Wine and Cheese Bar, 3 Fish Row, Salisbury**

I write with reference to the above application for a license for regulated entertainment and sales of alcohol at these premises.

My concern is around the level of disturbance that will be caused by this business being in operation six nights a week and its proximity to a new set of residential flats at Queens House apartments, 1 Fish Row, immediately next door to the proposed wine bar. There are seven flats in this block which are in a newly renovated and converted building over the commercial premises in Fish Row and New Canal, with the front door to this block being immediately next door to the proposed wine bar. Currently the commercial premises at this end of Fish Row operate only during usual daylight business hours. A wine bar is a significant change of use and cannot help but impact on the residents of Queens House, who have bought their flats after reviewing the surrounding business premises and in the belief that there would not be late night noise from those businesses.

I am particularly concerned about during the summer months, when I am sure that patrons of the wine bar will want to be drinking outside the bar, with doors and windows open and people moving between the bar and Fish Row and using the public seating outside the tourist information office immediately opposite the proposed wine bar. [REDACTED]

[REDACTED] I am very concerned about the level of noise from customers, especially in good weather as I have noted, but also at the end of any evening if patrons are reluctant to leave, and hang around outside the bar. This would mean that drinkers would be chatting late at night [REDACTED]

I also note that there is an application is for an entertainment licence; I fear this could cause more significant disturbance. I really do not wish to be disturbed in my own home by music or other amplified entertainment coming from a bar.

Please could I ask that these points be given serious consideration? I have recently moved to Salisbury and am delighted with both my flat and the city, but I can see this issue having a major impact on my quality of life in my own home.

Yours faithfully,

[REDACTED]

[REDACTED]

This page is intentionally left blank